

Frequently Asked Questions (FAQ's)

NAME OF THE SCHOOLS:

JAIN HERITAGE a CAMBRIDGE SCHOOLS (JHCS), Kondapur, Maharajpet & Shamirpet

JAIN Toddlers an International Play School, Kondapur & Mahindra Hills

CONTACT PERSON:

Hyderabad – Ms. Malini S (+91 9000676784)

Secunderabad – Mrs. Shashikala (+91 9949098880)

EMAIL ID: admissions@jainheritage.in

WEBSITE: www.jainheritage.in, www.toddlers.ac.in

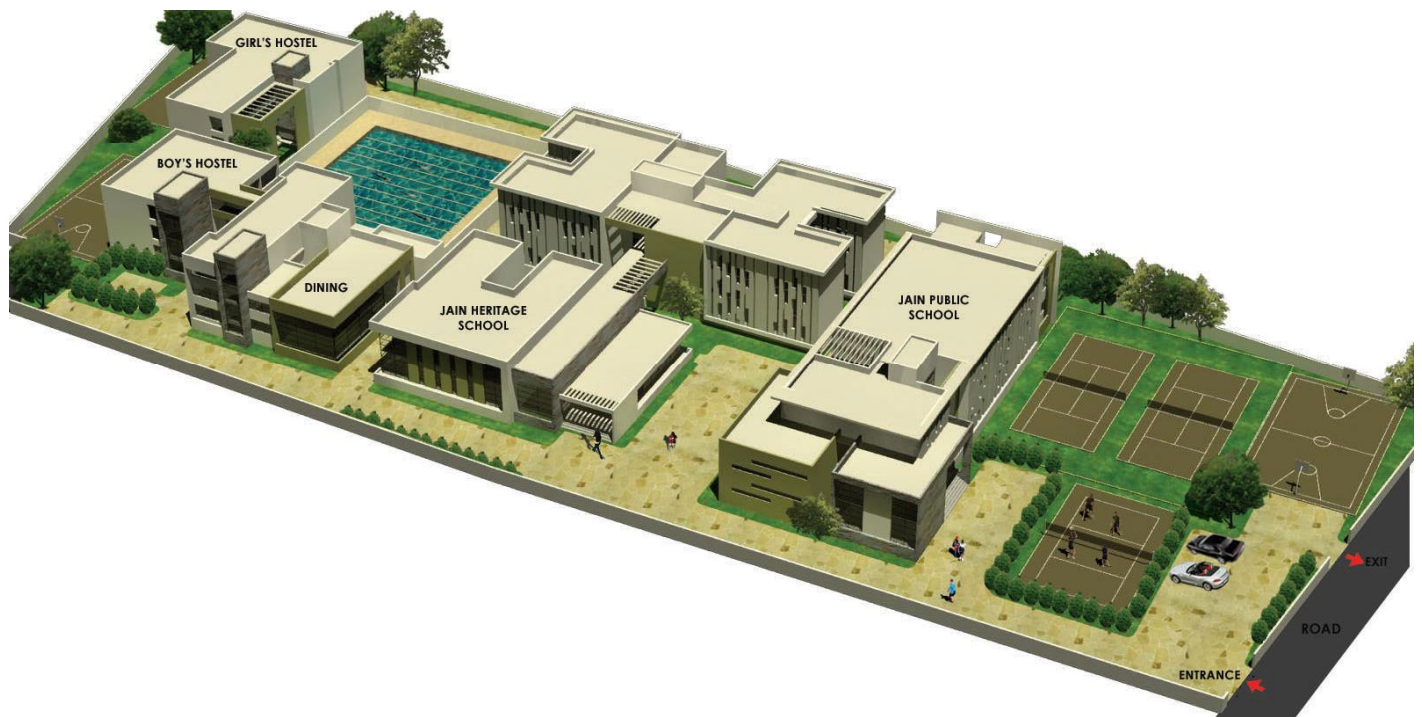

1. Which board or syllabus do you follow at your school?

- CBSE (Central board, New Delhi)
- IGCSE (Cambridge – CIE)

2. In which year was your school established? Please name some of the members of your Board.

Year of Establishment of the promoting group – 1990 (www.jgi.ac.in)

Year of Establishment of the schools at Hyderabad – 2008 (Jain Toddlers) 2009 (Jain Heritage School)

Board Members :- 1) Mr. Pickbrain Giri Balasubramaniam – Renowned Quizmaster

2) Mr. Senthil Kumaran – Principal Counselor – CII Institute of Quality

3) Mrs. Sheba Maini – Director, Centre for Education Management & Development

(Detailed list to be enclosed)

3. When does your academic year begin and end? Do you have any mid year admissions?

Our Academic year begins in 3rd week of June and ends in April. Yes, we do have mid-term admissions during the academic session.

4. What is the total strength of your school? How many branches do you have across the city/country?

The present strength of our schools in twin cities is 415 students and we have 6 branches in twin cities.

Total we have 60 plus branches across the country. (For detailed list refer www.jgi.ac.in)

5. What is your total annual fee? Do you offer any special discounts to Parents?

JHCS Annual Fee is around Rs. 80000/- (Approx)

Yes, we do offer sibling discounts and special corporate discounts in case of formal tie-up with the companies.

6. What are the timings of the school?

Pre-Primary:- 9:00am to 1pm (Monday to Fridays)

Primary & Secondary:- 8:30am to 4pm (Mondays to Saturdays)

7. What is the Teacher –student ratio?

1 : 10

8. How often do you have parent teacher meetings?

Once every term i.e., 3 times minimum in a year

9. What arrangements do you have for transport? Do you have a door pick up facility for the children?

Safe and Secure Air-conditioned busses.

Pre-Primary:- Door step Pick & Drop

Primary:- Common Points identified in close proximity

10. Do you have a canteen facility? What kind of hygiene standards do they follow?

Yes, we do have an in-house kitchen and we cater pure vegetarian nutritious breakfast, Juice, Lunch and Snacks to students everyday. (Detailed Menu to be attached)

11. Do you provide any scholarships for meritorious students?

Yes, depending on a case-to-case basis.

12. What kind of extracurricular activities do you encourage among the children? What kind of sports do you encourage at school?

We encourage all kinds of Extracurricular Activities:- Dance, Music, Drama, Theatre, Art & Craft. We have hobby classes by name KIDS KLUBs as well as NATYARPANA Academy for Classical Dance and Music.

For sports we have an academy by name Jain Academy of Sporting Excellence (JASE) for specialized coaching and regularly we offer Indoor:- Caroms, Chess, Table Tennis, Yoga, Taekwondo & Outdoor:- Cricket, Skating, Lawn Tennis, Badminton, Basket Ball, Volleyball and Athletics.

13. What hobby sessions do you have at your institute? Do you charge extra for that?

We have Kids Club, JASE Academy (Jain Academy for Sporting Excellence), Natyarpana Academy (Dance & Music). And charges vary from hobby to hobby and number of classes chosen.

14. What special provisions, if any, do you have for weak children/slow learners? Do you have a student counselor on campus?

Yes, we do take care of Slow Learners/Weak children. We do have on campus psychologically qualified student counselor and strongly believe in the Mentoring system and follow a well researched Remedial Teaching Methodology.

15. What kind of emergency medical facilities do you have on campus?

We have a fully equipped medical room with a full time qualified nurse on campus.

16. What kind of arrangements do you have for purchasing books and uniforms?

We provide the complete set of text books, note books, stationery, uniforms, and accessories required year long by the students at the school.

17. Does your school follow any specific philosophy different from other regular schools?

- ✓ Our Philosophy is that we believe – Every Child is Unique
- ✓ A learner centric approach encompassing child and the coach/facilitator
- ✓ Our creativity arises from Multiple Forms of Intelligences
- ✓ We nurture and strengthen the talents that reflect these intelligence
- ✓ Process learning, not only content learning
- ✓ Learning with fun
- ✓ Creating a stimulating and challenging learning environment
- ✓ Unique model ensuring ample time for children to study, play, rest, do homework and revise lessons.
- ✓ Give opportunity to spend quality time with their parents back home

- ✓ Reduces burden of the back-breaking school bag, which hinders the mental as well as physical growth of the child.
- ✓ Well qualified and experienced teachers
- ✓ Value based education
- ✓ Skill based learning and understanding of concepts by arranging field trips.
- ✓ World class education with firm grounding in traditional values.

Tapping into MULTIPLE INTELLIGENCES

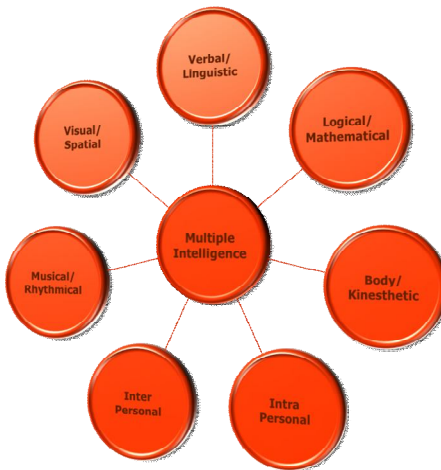

Children @ Jain Heritage

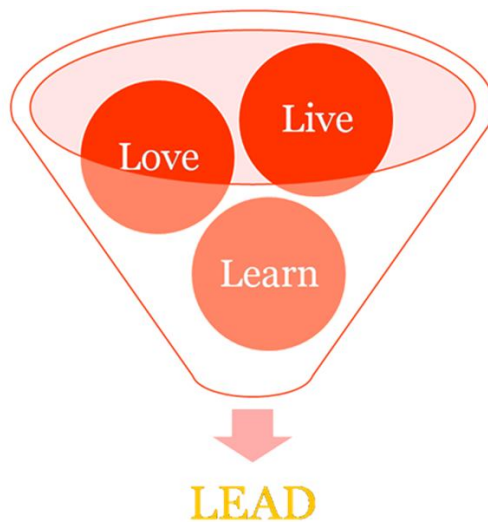

We thank you for your interest in JGI Schools. We hope that the information shared with you was fruitful. Do get in touch with us for any further information that we can help you with.